



City of Tacoma

## **Public Works Engineering Division**

**ADDENDUM NO. 2**

**DATE:** 1-26-2024

**REVISIONS TO:**  
**Request for Bids Specification No. PW23-0003F**  
**Streets Initiative Package #15**

### **NOTICE TO ALL BIDDERS:**

This addendum is issued to clarify, revise, add to or delete from, the original specification documents for the above project. This addendum, as integrated with the original specification documents, shall form the specification documents. The noted revisions shall take precedence over previously issued specification documents and shall become part of this contract.

### **REVISIONS TO THE SUBMITTAL DEADLINE:**

The submittal deadline remains the same.

### **REVISIONS TO THE PLANS:**

#### **Revision #1**

Replace the following project plan sheets with the attached plan sheets including Addendum 2 revisions (3 pages/plan sheets):

1. Sheet No. 19 / Sheet C-3 of C-11
2. Sheet No. 20 / Sheet C-4 of C-11
3. Sheet No. 21 / Sheet C-5 of C-11

### **REVISIONS TO THE SPECIFICATIONS:**

#### **Revision #1**

Replace contract specification section 2-14.5 with the following:

#### **2-14.5 Payment**

Payment will be made in accordance with Section 1-04.1.

“Remove Existing Pavement, Class\_\_\_\_”, per square yard.

All costs associated with saw cutting meet lines shall be included in the unit Contract price for pavement removal. All costs for varying types are included in the unit Contract price for removal of pavement of the specified class, no extra payment shall be made for varying types.



City of Tacoma

## Revision #2

Replace contract specification section 8-20.5 with the following:

### **8-20.5 Payment**

*The payment for the bid item "Conduit Pipe \_\_\_\_ In. Diam.", per linear foot is supplemented with the following:*

The cost per linear foot of conduit pipe includes the cost of providing the wires as shown on the Plans, and pulling all wire through the conduit pipe as shown on the Plans. All conduit shall be Schedule 80 PVC unless otherwise called out on the Plans or as directed by the Engineer.

*This section is supplemented with the following:*

"Remove and Replace Junction Box", per each.

The unit Contract price per each for "Remove and Replace Junction Box" shall be full pay for all work to remove the existing junction box, replacing or new placement of the junction box with the specified type and removed as shown in the Plans or as directed by the Engineer. The Contractor shall be responsible to confirm the type of Junction Box to be used and shall replace the Junction Box in-kind to the existing Junction Box. The costs for this work shall include all handling, hauling, disposing, furnishing, excavation, and placing the junction box. Any work to restore facilities, such as but not limited to, providing conduit, rerouting conduit, pulling wire, reconnecting the system and testing the system as directed by the Engineer shall be included in this bid item.

"Remove and Relocate Junction Box", per each.

The unit Contract price per each for "Remove and Relocate Junction Box" shall be full pay for all work to remove the existing junction box, and relocation of the junction box as shown in the Plans or as directed by the Engineer. The Contractor shall be responsible to confirm the type of Junction Box to be used and shall replace the Junction Box in-kind to the existing type of Junction Box. The costs for this work shall include all handling, hauling, disposing, furnishing, excavation, and placing the junction box. Any work to restore facilities, such as but not limited to, providing conduit, rerouting conduit, pulling wire, reconnecting the system and testing the system as directed by the Engineer shall be included in this bid item.



City of Tacoma

“Junction Box, Streetlighting”, per each.

The unit Contract price per each for “Junction Box, Streetlighting” shall be full pay for all work to install the junction box of the specified type as shown in the Plans or as directed by the Engineer. The costs for this work shall include all handling, hauling, disposing, furnishing, excavation, and placing the junction box. Any work to restore facilities, such as but not limited to, providing conduit, rerouting conduit, pulling wire, connecting conductors, reconnecting the system and testing the system as directed by the Engineer and the Plans shall be included in this bid item.

## **END OF SECTION**

### **REVISIONS TO THE PROPOSAL PAGES:**

#### **Revision #1**

Replace bid proposal in the bid submittal and specifications with the attached bid proposal with Addendum #2 noted at the top of each new bid proposal page.  
(8 pages)

NOTE: Acknowledge receipt of this addendum by initialing the corresponding space as indicated on the signature page. Vendors who have already submitted their bid/proposal may contact the Purchasing Division at 253-502-8468 and request return of their bid/proposal for acknowledgment and re-submittal. Or, a letter acknowledging receipt of this addendum may be submitted in an envelope marked Request for Bids Specification No. PW23-0003F Addendum No. 2. The City reserves the right to reject any and all bids, including, in certain circumstances, for failure to appropriately acknowledge this addendum.

cc: Basel Kitmitto, Public Works Engineering







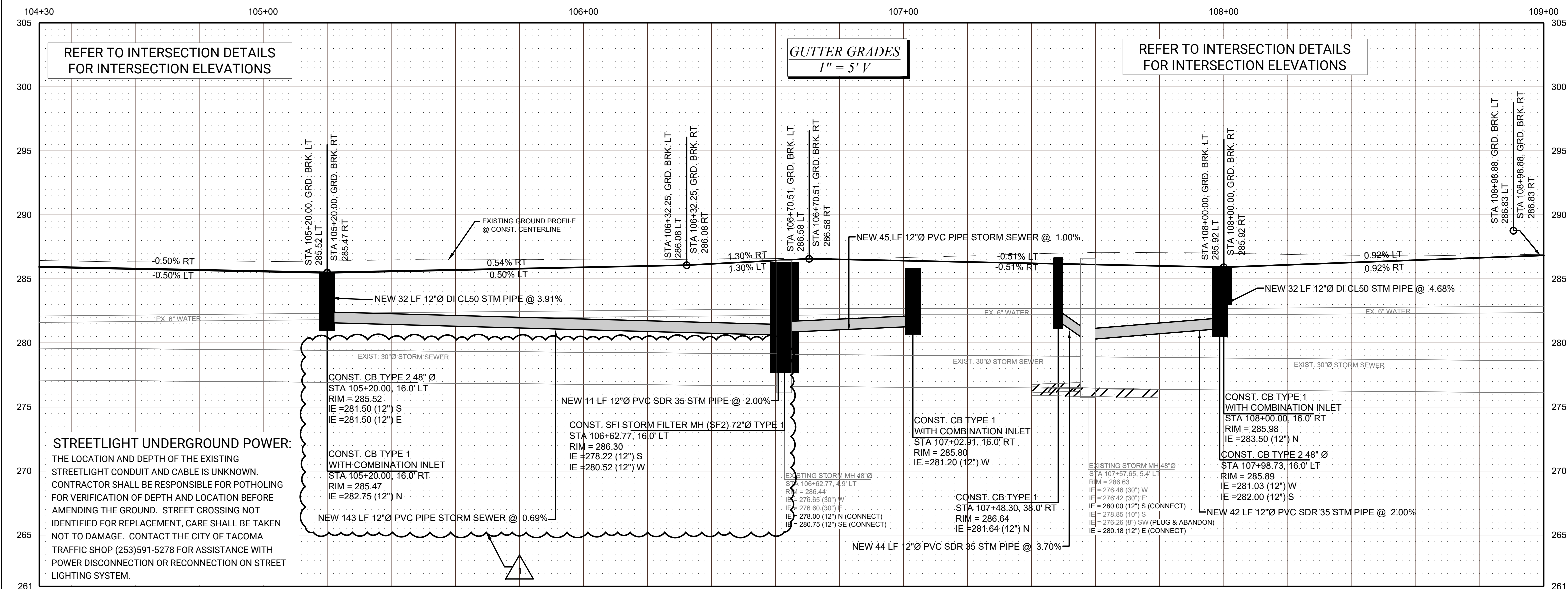
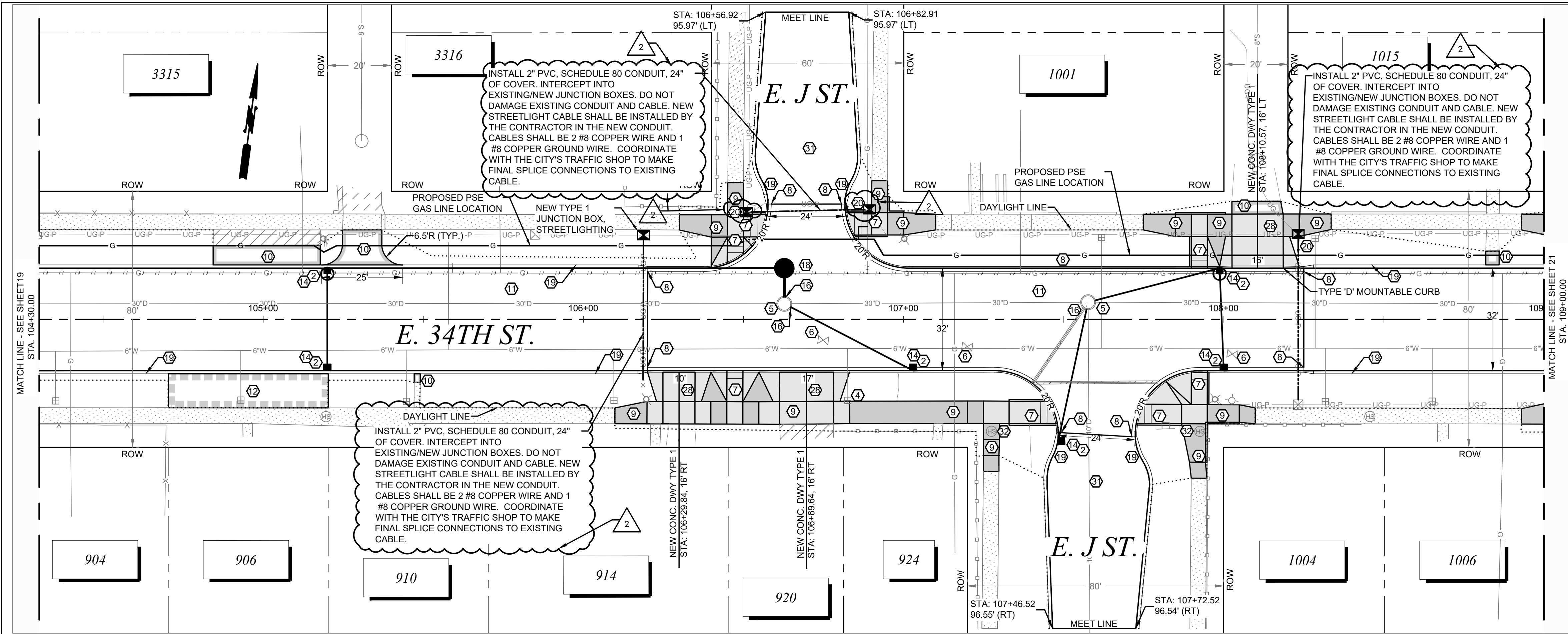

**CALL BEFORE YOU DIG**

EXISTING UTILITIES ARE SHOWN IN APPROXIMATE LOCATIONS ONLY PER BEST AVAILABLE INFO, AND MAY BE INCOMPLETE. CONTRACTOR SHALL BE RESPONSIBLE FOR LOCATING, POTHOLING AND AVOIDING ALL EXISTING UTILITIES.

CALL TWO BUSINESS DAYS BEFORE YOU DIG  
(1-800-424-5555) OR VISIT ONLINE: [www.callbeforeyoudig.org](http://www.callbeforeyoudig.org)

ADDENDUM 1

ADDENDUM 2

1/16/24

1/22/24

FINAL CONSTRUCTION CHECKED

DATE: JAN 2024

DESIGNED: RDR

DRAWN: REE

PROJECT NAME: PROP3-PKG15

DRAWING NAME: E\_34TH\_ST-CONST

SCALE: 1" = 20'

CHECKED: DCS

PROPOSED NAME: PROP3-PKG15

DATE: 01/24/2024

CITY OF TACOMA

DEPARTMENT OF PUBLIC WORKS

CONSTRUCTION PLAN

STREET INITIATIVE PKG 15

E 34TH ST FROM E MCKINLEY ST TO E L ST

PWK-00434-15

SHEET NO: 20

SHEET C-4 OF C-11

- ### CONSTRUCTION NOTES
- CONSTRUCT BRASS POURED MONUMENT (DISK FURNISHED) PER CITY OF TACOMA STANDARD PLAN SU-01. LOCATION TO BE DETERMINED BY THE CITY OF TACOMA
  - PROVIDE INLET PROTECTION PER SPECIFICATION 8-01 UNTIL END OF CONSTRUCTION ACTIVITIES
  - TO BE ADJUSTED BY OTHERS
  - TO BE RELOCATED BY OTHERS
  - ADJUST TO GRADE PER SPECIFICATION 7-05
  - ADJUST EXISTING VALVE PER CITY OF TACOMA STANDARD SU-37
  - CONSTRUCT CEMENT CONCRETE CURB RAMP PER CITY OF TACOMA STANDARD PLAN SU-05 SERIES
  - CONSTRUCT CEMENT CONCRETE TRAFFIC CURB AND GUTTER PER CITY OF TACOMA STANDARD PLAN SU-03
  - CONSTRUCT CEMENT CONCRETE SIDEWALK PER CITY OF TACOMA STANDARD PLAN SU-04
  - GRADE FOR POSITIVE DRAINAGE AND PLACE 2 INCH HMA OVER 2 INCH CRUSHED SURFACING TOP COURSE
  - CONSTRUCT HMA PAVEMENT PER CROSS SECTION FOR MATERIAL AND DEPTHS. DETAIL SHEET RS-1
  - GRADE FOR POSITIVE DRAINAGE AND PLACE 2 INCH CRUSHED SURFACING TOP COURSE
  - CONSTRUCT NEW MANHOLE (SEE PROFILE FOR SIZE AND TYPE)
  - CONSTRUCT NEW CATCH BASIN (SEE PROFILE FOR SIZE AND TYPE)
  - ADJUST CATCH BASIN PER SPECIFICATION 7-05
  - CONNECT NEW PIPE TO EXISTING STRUCTURE
  - RECONNECT EXISTING PIPE TO NEW STRUCTURE
  - CONSTRUCT NEW SFI STORMWATER QUALITY FILTER MANHOLE PER DETAIL SHEET SD-1
  - HMA WEDGE CURB SU-03
  - REMOVE AND REPLACE JUNCTION BOX
  - REMOVE AND RELOCATE MAILBOX PER PLAN ATTACHED IN APPENDIX
  - REMOVE AND RELOCATE SIGN
  - CONSTRUCT CEMENT CONCRETE 10" PAVEMENT
  - CONNECT DISSIMILAR PIPE
  - CONSTRUCT DIVERTER PER DETAIL ON SHEET 39
  - PRESERVE AND REINSTALL MAKERS MARK PER STANDARD PLAN SU-40
  - GRIND EXISTING PAVEMENT 2" AND OVERLAY WITH 2" HMA 1/2" PG 58H-22
  - CONSTRUCT CEMENT CONCRETE DRIVEWAY PER CITY OF TACOMA STANDARD PLAN SU-07 SERIES
  - CONSTRUCT CEMENT CONCRETE TRAFFIC CURB PER CITY OF TACOMA STANDARD PLAN SU-03 SERIES
  - CONSTRUCT CEMENT CONCRETE VALLEY GUTTER PER CITY OF TACOMA STANDARD PLAN SU-03 SERIES
  - SHAPE TO GRADE AND PLACE 2" HMA 1/2" PG 58H-22 OVER 4" CSBC
  - PRESERVE HISTORIC STAMP PER CITY OF TACOMA STANDARD PLAN SU-40

- ### GENERAL NOTES:
- ALL APPROACHES SHALL BE GRADED AND PLACED TO ENSURE POSITIVE DRAINAGE.
  - ADJUSTING STRUCTURES SUCH AS MANHOLES AND VALVE CHAMBERS SHALL BE DONE PER C.O.T. STANDARD DETAIL SU-25 AND SU-37.
  - WHEN REMOVING AN APPROACH THE LIMITS SHALL BE FROM THE EDGE OF THE APPROACH TO A MINIMUM OF 2' BEHIND THE NEW EDGE OF PAVEMENT.
  - MANHOLE STATIONING AND TYPE 2 CATCH BASIN STATIONING ARE TO CENTER OF STRUCTURE
- ### UTILITY NOTE:
- UTILITIES SHOWN ARE FROM SUB-CONSULTANT SURVEY AND CITY OF TACOMA GIS INFORMATION AND MAY NOT BE REPRESENTATIVE OF ACTUAL LOCATION. IT IS THE CONTRACTOR'S RESPONSIBILITY TO VERIFY THROUGH UTILITY LOCATE SERVICES, UTILITY AS-BUILT DRAWINGS, RECORD DRAWINGS AND POTHOLING THE HORIZONTAL AND VERTICAL LOCATION OF EXISTING UTILITIES. ALL MEANS AND METHODS TO RESEARCH AND VERIFY EXISTING UTILITY LOCATIONS SHALL BE INCIDENTAL TO THE ASSOCIATED WORK.

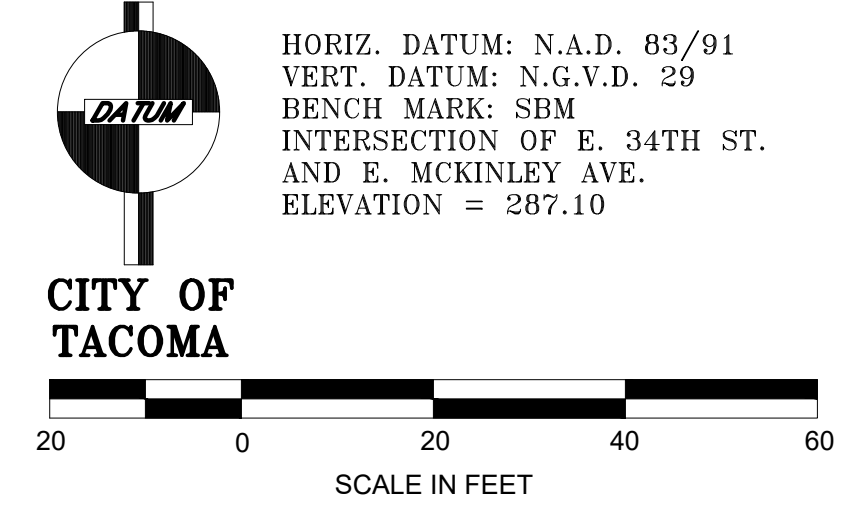



LESS C-5 OF C-11

**BID PROPOSAL**

SPECIFICATION NO. PW23-0003F  
Streets Initiative Package #15

The undersigned hereby certifies that he/she has examined the location and construction details of work as outlined on the Plans and Specifications for Project No. PWK-00434-15 and has read and thoroughly understands the Plans and Specifications and contract governing the work embraced in this improvement and the method by which payment will be made for said work, and hereby proposes to undertake and complete the work embraced in this improvement in accordance with said Plans, Specifications and contract and at the following schedule of rates and prices:

- NOTE: 1. Unit prices of all items, all extensions and total amount of bid should be shown. Show unit prices in figures only.
2. The notations below the item numbers refer to the specification section where information may be found regarding each contract item. These notations are intended only as a guide and are not warranted to refer to all specification sections where information may be found.

All bid items are sorted in the following group:

**Schedule A: Roadway, Bid Items R-1 – R-82**

Contractor's Name: \_\_\_\_\_  
Specification No. PW23-0003F  
Page 1 of 8

**Schedule A: Roadway****Addendum #2**

<u>ITEM NO.</u>	<u>ITEM DESCRIPTION</u>	<u>ESTIMATED QUANTITY</u>	<u>UNIT PRICE</u>	<u>TOTAL AMOUNT</u>
R-1. 1-05	Roadway Surveying	1 Lump Sum	Lump Sum	\$_____
R-2. 1-05	Project Redline Drawings	1 Lump Sum	Lump Sum	\$_____
R-3. 1-07	SPCC Plan	1 Lump Sum	Lump Sum	\$_____
R-4. 1-09	Mobilization	1 Lump Sum	Lump Sum	\$_____
R-5. 1-10	Pedestrian Traffic Control	1 Lump Sum	Lump Sum	\$_____
R-6. 1-10	Project Temporary Traffic Control	1 Lump Sum	Lump Sum	\$_____
R-7. 2-01	Clearing and Grubbing	1 Lump Sum	Lump Sum	\$_____
R-8. 2-01	Certified Arborist	1 Lump Sum	Lump Sum	\$_____
R-9. 2-02	Removal of Structures and Obstructions	1 Lump Sum	Lump Sum	\$_____
R-10. 2-03	Existing Irrigation Systems	1 Force Account	Estimated	<u>\$7,500.00</u>
R-11. 2-03	Roadway Excavation Incl. Haul	5340 Cu. Yd.	\$_____	\$_____
R-12. 2-03	Gravel Borrow Incl. Haul	49 Ton	\$_____	\$_____
R-13. 2-06	Subgrade Maintenance and Protection Plan	1 Lump Sum	Lump Sum	\$_____
R-14. 2-09	Shoring or Extra Excavation Class B	13869 Sq. Ft.	\$_____	\$_____
R-15. 2-09	Structure Excavation Class B	1881 Cu. Yd.	\$_____	\$_____

Contractor's Name: \_\_\_\_\_

Specification No. PW23-0003F

Page 2 of 8



**Schedule A: Roadway****Addendum #2**

<u>ITEM NO.</u>	<u>ITEM DESCRIPTION</u>	<u>ESTIMATED QUANTITY</u>	<u>UNIT PRICE</u>	<u>TOTAL AMOUNT</u>
R-16. 2-14	Remove Existing Pavement, Class A2	875 Sq. Yd.	\$ _____	\$ _____
R-17. 2-14	Remove Existing Pavement, Class A4	12600 Sq. Yd.	\$ _____	\$ _____
R-18. 2-14	Remove Existing Pavement, Class C6	1375 Sq. Yd.	\$ _____	\$ _____
R-19. 2-14	Remove Existing Pavement, Class C12	125 Sq. Yd.	\$ _____	\$ _____
R-20. 2-14	Remove Existing Pavement, Class CA	550 Sq. Yd.	\$ _____	\$ _____
R-21. 2-15	Remove Curb	370 Lin. Ft.	\$ _____	\$ _____
R-22. 2-16	Remove Catch Basin	24 Each	\$ _____	\$ _____
R-23. 2-16	Remove Manhole	2 Each	\$ _____	\$ _____
R-24. 4-04	Crushed Surfacing Top Course	1262 Ton	\$ _____	\$ _____
R-25. 4-04	Crushed Surfacing Base Course	3529 Ton	\$ _____	\$ _____
R-26. 5-04	Planing Bituminous Pavement	380 Sq. Yd.	\$ _____	\$ _____
R-27. 5-04	HMA for Approach CL 1/2" PG 58H-22	375 Sq. Yd.	\$ _____	\$ _____
R-28. 5-04	HMA CL 1/2" PG 58H-22	3918 Ton	\$ _____	\$ _____
R-29. 5-05	Cement Conc. Pavement 10- Inch Section	125 Sq. Yd.	\$ _____	\$ _____
R-30. 7-05	Adjust Catch Basin	1 Each	\$ _____	\$ _____
R-31. 7-05	Catch Basin Type 2	12 Each	\$ _____	\$ _____

Contractor's Name: \_\_\_\_\_

Specification No. PW23-0003F

Page 3 of 8

**Schedule A: Roadway****Addendum #2**

<u>ITEM NO.</u>	<u>ITEM DESCRIPTION</u>	<u>ESTIMATED QUANTITY</u>	<u>UNIT PRICE</u>	<u>TOTAL AMOUNT</u>
R-32. 7-05	Adjust Manhole	17 Each	\$ _____	\$ _____
R-33. 7-05	Adjust Existing Valve Chamber to Grade	31 Each	\$ _____	\$ _____
R-34. 7-05	Catch Basin Type 1	33 Each	\$ _____	\$ _____
R-35. 7-05	Manhole 48 In. Diam. Type 1	7 Each	\$ _____	\$ _____
R-36. 7-05	Manhole 48 In. Diam. Type 1, with Cast-in-Place Base	2 Each	\$ _____	\$ _____
R-37. 7-05	Manhole 72 In. Diam. Type 1	1 Each	\$ _____	\$ _____
R-38. 7-05	Manhole Additional Height 48 In. Diam. Type 1	14 Lin. Ft.	\$ _____	\$ _____
R-39. 7-05	Connect New Sewer Pipe to Existing Structure	16 Each	\$ _____	\$ _____
R-40. 7-05	Pothole Existing Utility	50 Lin. Ft.	\$ _____	\$ _____
R-41. 7-05	Reconnect Existing Sewer Pipe to New Structure	13 Each	\$ _____	\$ _____
R-42. 7-05	SFI Storm Filter Manhole 72 In. Diam.	2 Each	\$ _____	\$ _____
R-43. 7-05	30x60 Type BB Inlet	2 Each	\$ _____	\$ _____
R-44. 7-08	Temporary Storm Sewer Bypass	1 Lump Sum	Lump Sum	\$ _____
R-45. 7-08	Temporary Storm Sewer Bypass Plan	1 Lump Sum	Lump Sum	\$ _____
R-46. 7-08	CDF for Pipe Abandonment	26 Cu. Yd.	\$ _____	\$ _____

Contractor's Name: \_\_\_\_\_

Specification No. PW23-0003F

Page 4 of 8



**Schedule A: Roadway****Addendum #2**

<u>ITEM NO.</u>	<u>ITEM DESCRIPTION</u>	<u>ESTIMATED QUANTITY</u>	<u>UNIT PRICE</u>	<u>TOTAL AMOUNT</u>
R-47. 7-08	Plugging Existing Pipe	32 Each	\$ _____	\$ _____
R-48. 7-17	Removal and Replacement of Unsuitable Material	1351 Cu. Yd.	\$ _____	\$ _____
R-49. 7-17	PVC Storm Sewer Pipe 18 In. Diam.	391 Lin. Ft.	\$ _____	\$ _____
R-50. 7-17	Ductile Iron Sewer Pipe 8 In. Diam.	41 Lin. Ft.	\$ _____	\$ _____
R-51. 7-17	PVC Storm Sewer Pipe 12 In. Diam.	1208 Lin. Ft.	\$ _____	\$ _____
R-52. 7-17	Ductile Iron Sewer Pipe 12 In. Diam.	373 Lin. Ft.	\$ _____	\$ _____
R-53. 8-01	Erosion/Water Pollution Control	1 Lump Sum	Lump Sum	\$ _____
R-54. 8-01	Stormwater Pollution Prevention Plan (SWPPP)	1 Lump Sum	Lump Sum	\$ _____
R-55. 8-01	NPDES Construction Stormwater General Permit	1 Lump Sum	Lump Sum	\$ _____
R-56. 8-02	Site Restoration	1 Lump Sum	Lump Sum	\$ _____
R-57. 8-02	Plant Selection	3 Each	\$ _____	\$ _____
R-58. 8-04	Cement Conc. Traffic Curb and Gutter	2980 Lin. Ft.	\$ _____	\$ _____
R-59. 8-04	Cement Conc. Pedestrian Curb	820 Lin. Ft.	\$ _____	\$ _____
R-60. 8-04	Cement Conc. Valley Gutter	630 Lin. Ft.	\$ _____	\$ _____
R-61. 8-04	Cement Conc. Type 'D' Mountable Curb	25 Lin. Ft.	\$ _____	\$ _____
R-62. 8-06	Cement Conc. Driveway Entrance	365 Sq. Yd.	\$ _____	\$ _____

Contractor's Name: \_\_\_\_\_

Specification No. PW23-0003F

Page 5 of 8

**Schedule A: Roadway****Addendum #2**

<u>ITEM NO.</u>	<u>ITEM DESCRIPTION</u>	<u>ESTIMATED QUANTITY</u>	<u>UNIT PRICE</u>	<u>TOTAL AMOUNT</u>
R-63. 8-09	Raised Pavement Marker Type 2	2 Per 100	\$ _____	\$ _____
R-64. 8-13	Poured Monument	6 Each	\$ _____	\$ _____
R-65. 8-14	Cement Conc. Sidewalk	1300 Sq. Yd.	\$ _____	\$ _____
R-66. 8-14	Cement Conc. Curb Ramp	49 Each	\$ _____	\$ _____
R-67. 8-14	Concrete Art Stamp	22 Each	\$ _____	\$ _____
R-68. 8-18	Remove and Relocate Mailbox	2 Each	\$ _____	\$ _____
R-69. 8-20	Remove and Replace Junction Box	7 Each	\$ _____	\$ _____
R-70. 8-20	Junction Box, Streetlighting	5 Each	\$ _____	\$ _____
R-71. 8-20	Conduit Pipe 2 In. Diam.	455 Lin. Ft.	\$ _____	\$ _____
R-72. 8-21	Permanent Signing	1 Lump Sum	Lump Sum	\$ _____
R-73. 8-22	Plastic Wide Line	3155 Lin. Ft.	\$ _____	\$ _____
R-74. 8-22	Plastic Line	3150 Lin. Ft.	\$ _____	\$ _____
R-75. 8-22	Plastic Stop Line	115 Lin. Ft.	\$ _____	\$ _____
R-76. 8-22	Plastic Traffic Arrow	2 Each	\$ _____	\$ _____
R-77. 8-22	Plastic Crosswalk Line	960 Lin. Ft.	\$ _____	\$ _____

Contractor's Name: \_\_\_\_\_

Specification No. PW23-0003F

Page 6 of 8



**Schedule A: Roadway****Addendum #2**

<u>ITEM NO.</u>	<u>ITEM DESCRIPTION</u>	<u>ESTIMATED QUANTITY</u>	<u>UNIT PRICE</u>	<u>TOTAL AMOUNT</u>
R-78. 8-22	Plastic Bicycle Lane Symbol	17 Each	\$ _____	\$ _____
R-79. 8-22	Plastic Sharrow Symbol	8 Each	\$ _____	\$ _____
R-80. 8-32	Traffic Diverter	2 Each	\$ _____	\$ _____
R-81. 8-33	Historic Stamp Preservation	10 Each	\$ _____	\$ _____
R-82. 8-20	Conduit Pipe 3 In. Diam.	550 Lin. Ft.	\$ _____	\$ _____

**Roadway Base Bid Subtotal (Bid Items No. R-1 – R-82)**      \$ \_\_\_\_\_ (1)

**TOTAL BASE BID (1)**      \$ \_\_\_\_\_ (1)

**Schedule A: Roadway Improvements**

**Proposal for Incorporating Recycled Materials into the Project**

In compliance with RCW 70A.205.700, the Bidder shall propose below, the total percent of construction aggregate and concrete materials to be incorporated into the Project that are recycled materials. Calculated percentages must be within the amounts allowed in Section 9-03.21(1)E, Table on Maximum Allowable Percent (By Weight) of Recycled Material, of the Standard Specifications.

Proposed total percentage: \_\_\_\_\_ percent.

*Note: Use of recycled materials is highly encouraged within the limits shown above, but does not constitute a Bidder Preference, and will not affect the determination of award, unless two or more lowest responsive Bid totals are exactly equal, in which case proposed recycling percentages will be used as a tie-breaker, per the APWA GSP in Section 1-03.1 of the Special Provisions. Regardless, the Bidder's stated proposed percentages will become a goal the Contractor should do its best to accomplish. Bidders will be required to report on recycled materials actually incorporated into the Project, in accordance with the APWA GSP in Section 1-06.6 of the Special Provisions.*

**Bidder:** \_\_\_\_\_

**Signature of Authorized Official:** \_\_\_\_\_

**Date:** \_\_\_\_\_

Contractor's Name: \_\_\_\_\_

Specification No. PW23-0003F





City of Tacoma

## Questions and Answers

### **Streets Initiative Package #15** RFB Specification No. **PW23-0003F**

All interested parties had the opportunity to submit questions in writing by email to Brandon Snow, Senior Buyer, by date questions were due. The answers to the questions received are provided below and posted to the City's website at [www.TacomaPurchasing.org](http://www.TacomaPurchasing.org). Navigate to [Current Contracting Opportunities](#) / *Public Works and Improvements Solicitations*, and then click *Questions and Answers* for this Specification. This information IS NOT considered an addendum. Respondents should consider this information when submitting their proposals.

**Question 1: Plan sheet 53 shows a detail for planting and restoration. In the upper left corner is a "E. 64th Street Tree Schedule" that shows 20 trees to be planted. In review of the other plan sheets, I can only find 3 street trees to be installed. Please clarify the street tree schedule and how many trees are to be planted for this project**

Answer 1: Clarification to the street tree schedule has been provided in Addendum 1 with a plan sheet revision.

**Question 2: R-69, Remove and replace junction boxes, 5 each. I count 8. R-71, Street Light, there is no method of payment noted in the specials. There is no bid items for page 19, which has type 2 junction boxes, 2" conduit and 3" conduit. Nor do the specials note any method of payment.**

Answer 2: Discrepancies noted in the above comment submitted to the City have been addressed in Addendum 2 with specification plan and quantity revisions.

**Question 3: Material suppliers have submitted questions about material substitute approvals during the bidding period prior to bid opening.**

Answer 3: The City does not provide material approvals prior to bid opening or prior to contract execution. The Contractor is required to comply with the material requirements identified in the contract documents.